

For any questions that involve circles, use the π button and round to the nearest tenth.

1. Find the area of a rectangle if the length is $8y$ and the width is $(15 - y)$
2. Find the perimeter of a triangle if the sides lengths are $(5x + 1)$, $(11x - 10)$, and $(3x - 6)$.
3. Find the circumference of a circle if the diameter is $40m$.

4. What is the area of a semicircle if the radius is $30b$.

5. If the area of the parallelogram below is 102, find the value of x .

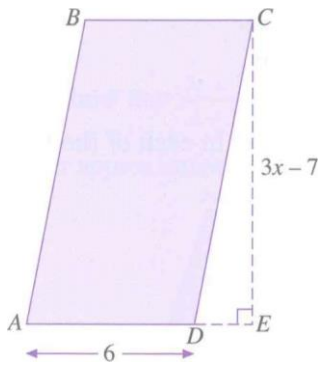

6. If the area of the triangle is 4131, then find the value of x .

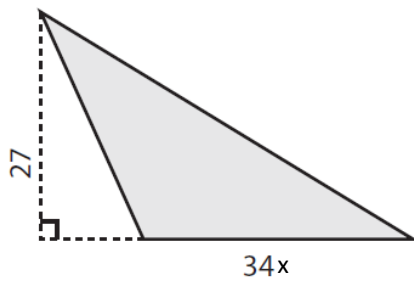

7. Find the area of the triangle.

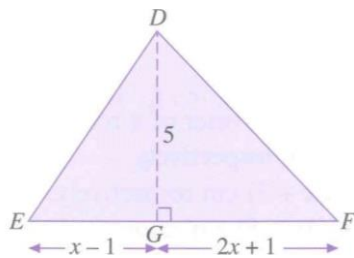

8. Find the area of the composite figure below.

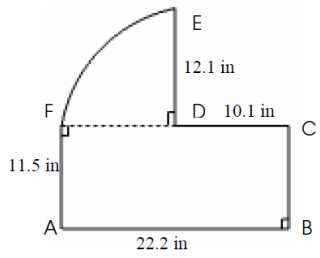

9. Find the perimeter of the composite figure below.

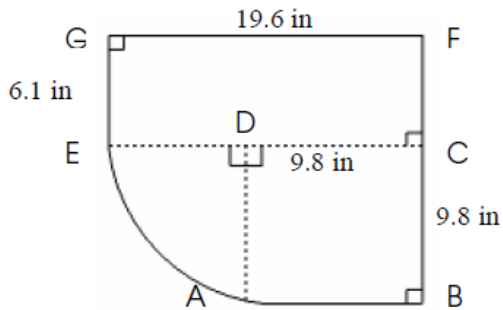

10. Find the area of the shaded region below.

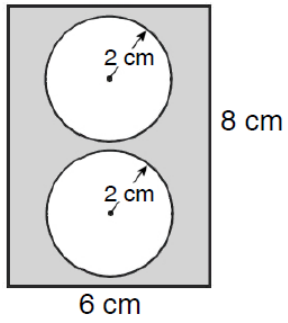

11. Find the area of the shaded region below.

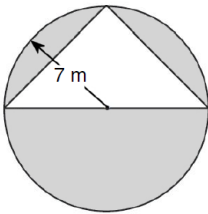

12. If the area of a circle is 36π then find the diameter.

13. Find the area AND perimeter of the composite figure below.

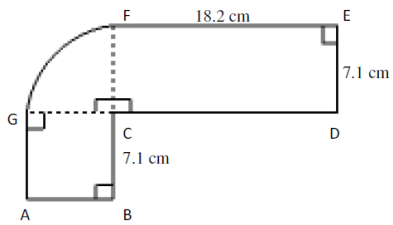

ANSWER KEY

1. $A = 120y - 8y^2$

2. $P = 19x - 15$

3. $C = 125.7m$

4. $A = 1413.7b^2$

5. $x = 8$

6. $x = 9$

7. $A = \frac{15x}{2}$

8. $A = 370.3$

9. $P = 66.8$

10. $A = 22.9$

11. $A = 104.9$

12. $D = 12$

13. $A = 219.2$ and $P = 76.0$